

## Site Map First Floor

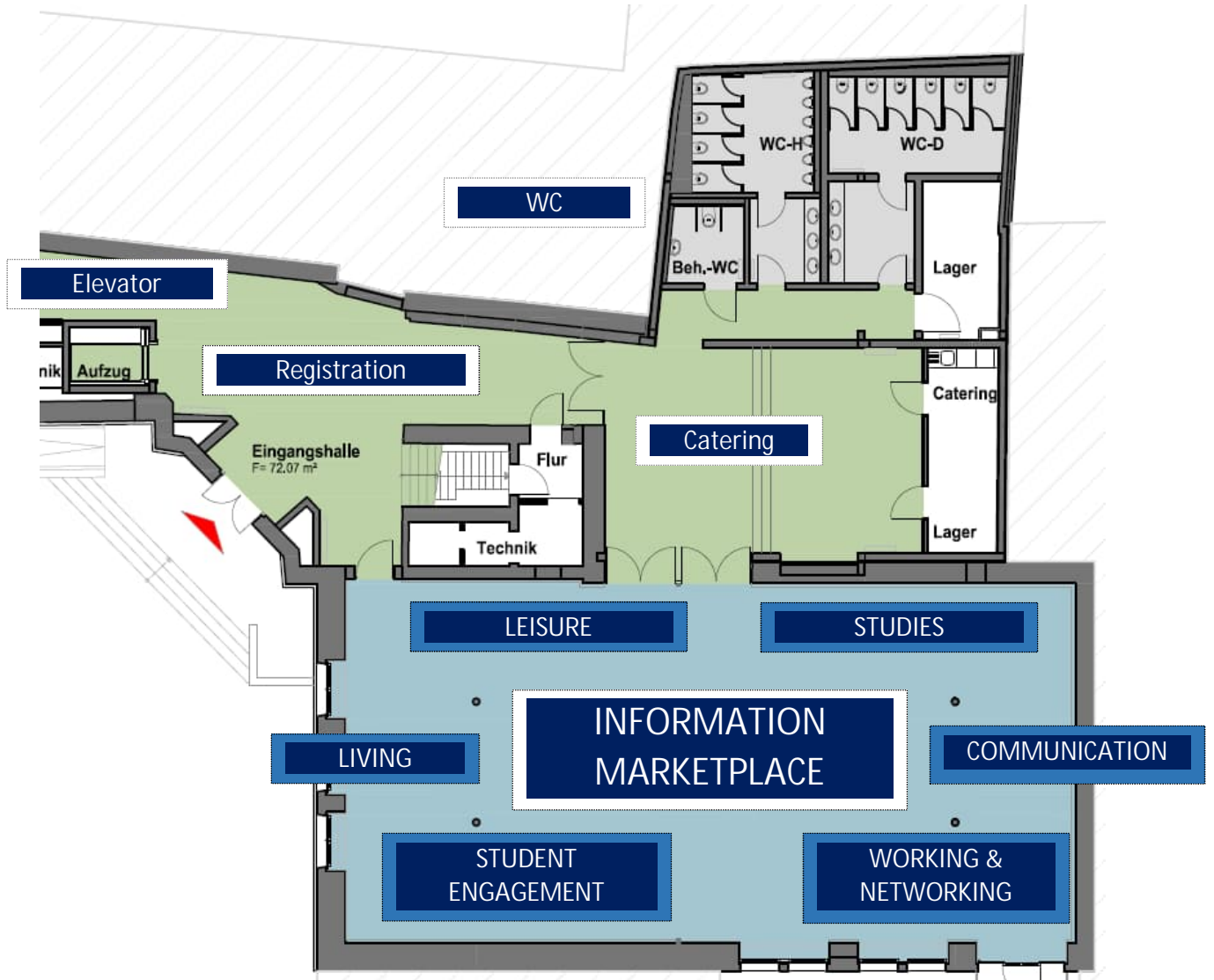

Please note:

The Welcome Ceremony will take place from 1:00-2:00 p.m. in the Adam-von-Trott Hall on the upper level.

---

Tagungshaus Alte Mensa  
am Wilhelmsplatz 3  
37073 Göttingen  
[Google Link](#)

## Information Marketplace – List of Participating Organizations

| Topic   | Stand | Organization  |
|---|-------|---|
| <b>Studies</b>                                      |       |   |
|   | 1     | eCampus & StudIT – IT-Services for Students                     |
|   | 2     | Erasmus & Exchange Student Support Services                     |
|   | 3     | Study Abroad Advisory Services                                  |
|   | 4     | Ombudsperson and Complaint Management for Teaching and Learning |
|   | 5     | Anti-discrimination counselling                                 |
|   | 6     | Centre for Languages and Transferable Skills (ZESS)             |
|   | 7     | SUB University Library  |
|   | 8     | Forum Wissen – Museum of Knowledge                              |
| <b>Communication</b>                                |       |   |
|   | 9     | German as a Foreign Language (DAF)                              |
|   | 10    | Intercultural Learning Lab (ICL)                                |
|   | 11    | International Writing Lab (ISL)                                 |
|   | 12    | InDiGu-Plus   |
| <b>Working &amp; Networking</b>                     |       |   |
|   | 13    | Career Service  |
|   | 14    | Start Guides – Career start for international graduates         |
| <b>Student Engagement</b>                           |       |   |
|   | 15    | General Student Committee (ASTA)                                |
|   | 16    | Erasmus Student Network Göttingen (ESN)                         |
|   | 17    | German Association for International Students (DEGIS)           |
| <b>Living &amp; Leisure Activities in Göttingen</b> |       |   |
|   | 18    | Foreigner's Registration Office, City of Göttingen              |
|   | 19    | TK Health Insurance   |
|   | 20    | Accommodation Service   |
|   | 21    | Social Service Studierendenwerk                                 |
|   | 22    | Psychosocial Counseling Centre (PSB)                            |
|   | 23    | AOK Health Insurance  |
|   | 24    | Foyer International   |
|   | 25    | Theater in OP (ThOP)  |
|   | 26    | Catholic University Community (KHG)                             |
|   | 27    | Barmer Health Insurance   |
|   | 28    | AIIESEC Social Projects & Internships Abroad                    |
|   | 29    | Music & Choir in Göttingen                                      |
|   | 30    | University Sport Centre   |